

MAGNETIC SPOT LIGHT

TECHNICAL SHEET
MAG-ST-4812/4815



KEYLIGHT

SPAIN
PRODUCTOS DE ILUMINACION

DRAWING

MAG-ST-4812

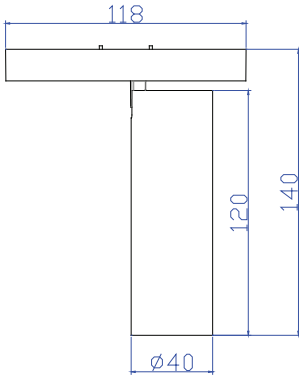

MAG-ST-4815

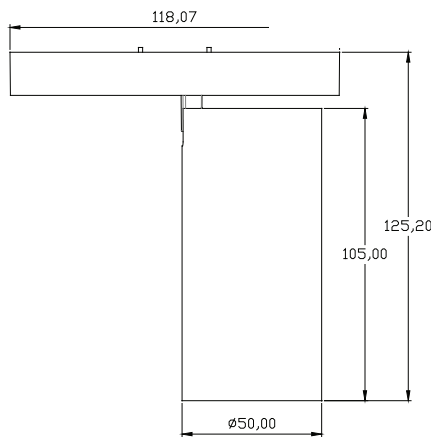

SPECIFICATIONS

Product Code	MAG-ST-4812	MAG-ST-4815
Input Current	48VDC	
Chip	2835	
Beam Angle	15°/24°/36°	
Efficacy(lm/W)	85 lm/W	
Power	12W	15W
Color Temperature	3000/4000/6000k	
Operating Temperature	-20 to +40	
Lamp Holder	Soft Fiber PCB	
Total light output	1020 lm	1275 lm
Installation	Magnetic attraction	
IP Rating	IP20	
Dimensions	40mm*120mm*118mm	50mm*125mm*118mm
Warranty	5 Years	